

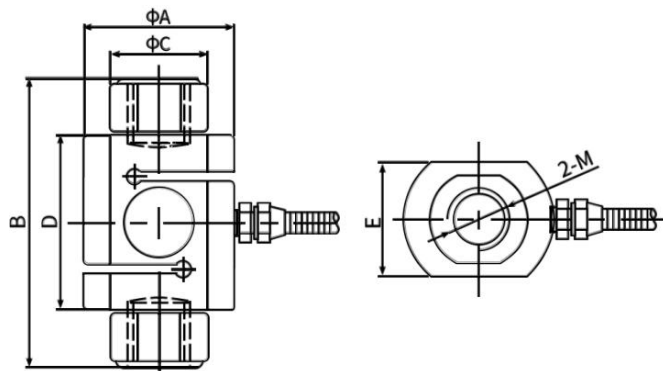

外形尺寸/ Dimensions



特点和用途 / Features & Applications

- 拉压双向，易于安装
- 适用于拉压试验机，料斗秤，吊钩秤，包装秤，皮带秤，插拔力测试仪等拉压力测试仪器以及自动化设备
- ❖ Double traction pressure for easy installation
- ❖ Applicable to pull pressure tester, hopper scale, lifting hook scale, packing scale, belt scale, Pull-in pressure test instruments such as plug and force tester and automatic equipment

选型表 / Features & Applications

量程 Cap	ØA	B	ØC	D	E	M
0~1t	44	88	28	56	26	M8*1.25
1~5t	58	112	38	68	44	M12*1.75
10t	84	160	60	104	58	M12*1.75
20t	88	156	68.5	108	76	M16*2

技术参数 / Technical Parameters

量程 Capacity	0g~20t	绝缘阻抗 Insulation	≥5000MΩ/100V DC
额定输出 Rated output	2.0mV/V	温度补偿范围 Compensated temp range	-10°C ~ 60°C
滞后 Hysteresis	0.05 % R.O.	工作温度范围 temp range	-20°C ~ 80°C
重复性 Repeatability	0.03% R.O.	推荐激励电压 Recommended excitation	5~10V DC
非线性 Non-linearity	0.05% R.O.	安全载荷 Safe overload	150% R.C.
零点输出 Zero balance	±1% R.O.	最大负载 Ultimate overload	200% R.C.
蠕变 Creep	0.05% R.O.	响应频率 Response frequency	10KHZ
零点温漂 Temp.effect on zero	0.05 % R.O. / 10°C	材质 Material	合金钢
灵敏度温漂 Temp.effect on output	0.05% R.O. / 10°C	电缆线规格 Cable Specifications	Ø5*3m:0~2t Ø5*5m:3~20t
输入阻抗 Input impedance	350 Ω	电缆极限拉力 Cable Ultimate pull	10kg
输出阻抗 Out impedance	350 Ω	TEDS	可选

接线图 / Schematic Wiring Diagram

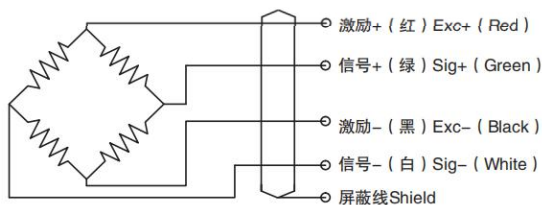

注：屏蔽线不与弹性体相连。

Note: Cable shield is not connected to element.

受力方式/ Force Direction

